

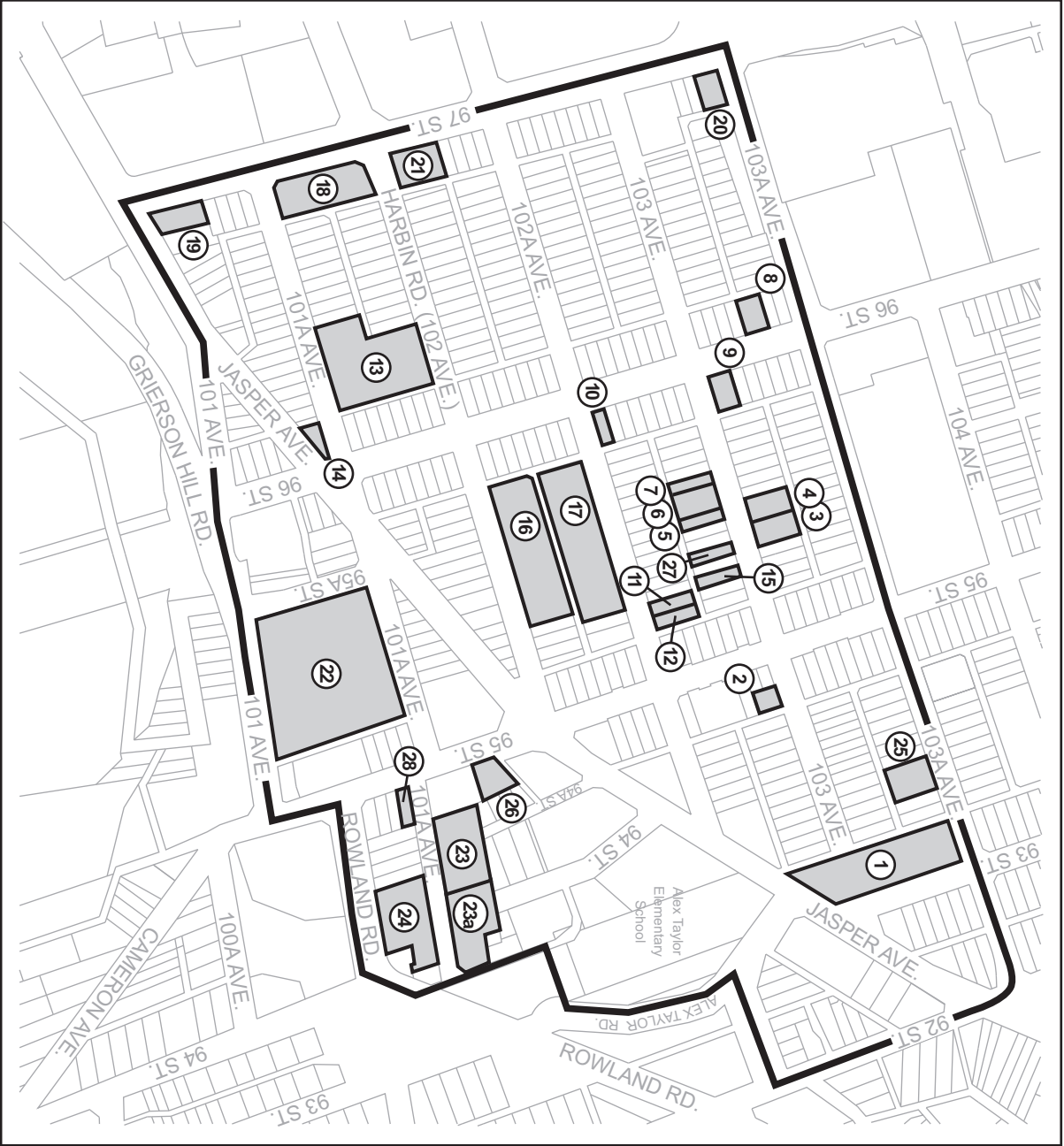

DRAFT - NON MARKET HOUSING



Ref. Number and Name	Address	Units	Housing Type	No. of People
Privately Owned				
1 Pioneer Place	10310 - 99 Street NW	171	Seniors Housing	162
2 "G-C Place, E4C"	9355 - 103 Avenue NW	12	Low-income Housing	12
3 "NALTA, EPINSS"	9526 - 103 Avenue NW	16	Single Mental Health Patients	16
4 "Kriwin-Lucier House, EPINSS"	9526 - 103 Avenue NW	15	Single Mental Health Patients	15
5 "Grey House, EPINSS"	9539 - 103A Avenue NW	8	Single Mental Health Patients	8
6 "Crossroads Downtown, E4C"	9543/45/47 - 103 Avenue NW	4	"Transitional, Supportive Housing"	14
7 "Cornan House, EPINSS"	9549 - 103 Avenue NW	5	Single Mental Health Patients	5
8 "Bridgeway, EPINSS"	10320 - 96 Street NW	21	Single Mental Health Patients	21
9 "Batoma Place, EPINSS"	10301 - 96 Street NW	40	Long-term Supportive Housing for Singles and Youth	40
10 "Golden Nugget, E4C"	10237 - 96 Street NW	10	Low-income Housing	10
11 Wyser Manor II	9518 - 102A Avenue NW	20	Low-income Singles	20
12 Gateway	9514-102A Avenue NW	42	Rooming House	40
13 Salvation Army	9611 - 101A Avenue NW	174	125 Rms / 40 Beds - Transition Housing and Addiction Treatment	145
14 "WEAC, E4C"	9611 - 101A Avenue NW	10	Women's Emergency Shelter - 75 Beds (9 Emergency)	92
15 House on 103 Avenue & 95 St	9519 - 103 Avenue NW	24	Affordable Housing	24
16 Chinese Elders Mansion I	9550 - 102 Avenue NW	92	Seniors Housing	96
17 Chinese Elders Mansion II	9530 - 102 Avenue NW	98	Seniors Housing	108
18 City Market Apartments	97 Street between 101A and 102 Ave.	72	Affordable Housing	72
21 Edmonton Mennonite Centre for Newcomers - "The Haven"	10203 - 97 Street NW	5	Affordable Housing	25
23 Edmonton Inner City Housing Society	9356 - 101A Avenue NW	20	Affordable Housing - Apartment Building	20
23a Edmonton Inner City Housing Society	9342 - 101A Avenue NW	6	Affordable Housing - 9342-9352 Town Houses	29
24 Artspace Housing Co-Operative Ltd.	9323 - 101 Avenue NW	88	Co-operative Housing	200
25 Edmonton Inner City Housing Society	9321 - 103A Avenue NW	6	Affordable Housing - 9321-9329A Town Houses	26
26 Edmonton Inner City Housing Society	10155 - 95 Street NW	10	Affordable Housing	10
27 Dot For Haart	9527 - 103 Avenue NW	4	"Transitional, Supportive Housing"	5
Sub-Total		968		1191
<i>E4C - Edmonton City Centre Church Corporation</i>				
<i>EPINSS - Edmonton People in Need Shelter Society</i>				
<i>Note - #18 was not considered in Vision - only 817 units were presented for Policy Purposes</i>				
City Owned Rentals				
19 Goodridge Block	9696- Jasper Avenue NW	6	Affordable Housing - 18 units - 6 subsidized units	6
20 Stovill Block	10327-97 Street NW	15	Affordable Housing	15
28 House on 95 St & Rowland Road	10129-95 Street NW	6	Affordable Housing	6
Sub-Total		27		27
Canada Owned Properties				
22 RCMP Barracks/Grierson Centre/ Stan Daniels Healing Centre Native Counselling Services	9530-101 Avenue 9516-101 Avenue	30 21	Minimum security inmates NCSA provides a range of spiritual and correctional programs	30 72
Sub-Total		51		102
TOTAL		1046		1320

Further review by the Community Action Planning Group



Special Projects Office
September 2008

The Quarters Project Area