

Bylaw 15247

Closure of a portion of road right-of-way  
located at Block 17, Plan 7921635

---

WHEREAS the Municipal Council of the City of Edmonton may pass a Bylaw for the purpose of closing any road provided that the bylaw is advertised and any person who claims to be affected prejudicially by the bylaw, or their agent, has been given an opportunity of being heard by City Council in relation to the proposed Bylaw; and

WHEREAS City Council has considered the proposed closing and has agreed that it is in the public interest to pass this Bylaw;

NOW THEREFORE the Municipal Council of the City of Edmonton, duly assembled, enacts as follows:

1. All that portion of road generally as shown on Schedule "A" is hereby closed.
2. When title or titles are created for the former portion of road as described in Section 1 of this Bylaw, it is understood and agreed that such title or titles for the former portion of road may be issued excepting Mines and Minerals, the City however, reserving the right to the said Mines and Minerals if in fact the City is the owner thereof.

3. When title or titles are created for the former portion of road as described in Section 1 of this Bylaw, such titles shall be described in Appendix I, which is attached to this Bylaw but does not form part of this Bylaw.

4. When title or titles are created for the former portion of road as described in Section 1 of this Bylaw, the area shown as PUL on Schedule "A" is hereby designated as a public utility lot pursuant to section 665(2)(b) of the Municipal Government Act c. M-26 R.S.A. 2000.

READ a first time this	20th	day of	July	, A. D. 2009;
READ a second time this	20th	day of	July	, A. D. 2009;
READ a third time this	20th	day of	July	, A. D. 2009;
SIGNED and PASSED this	20th	day of	July	, A. D. 2009.

THE CITY OF EDMONTON

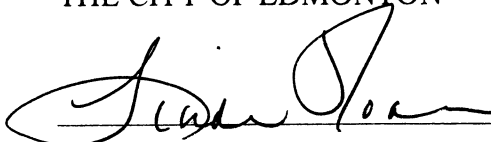
  
MAYOR

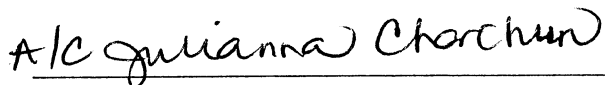
  
CITY CLERK

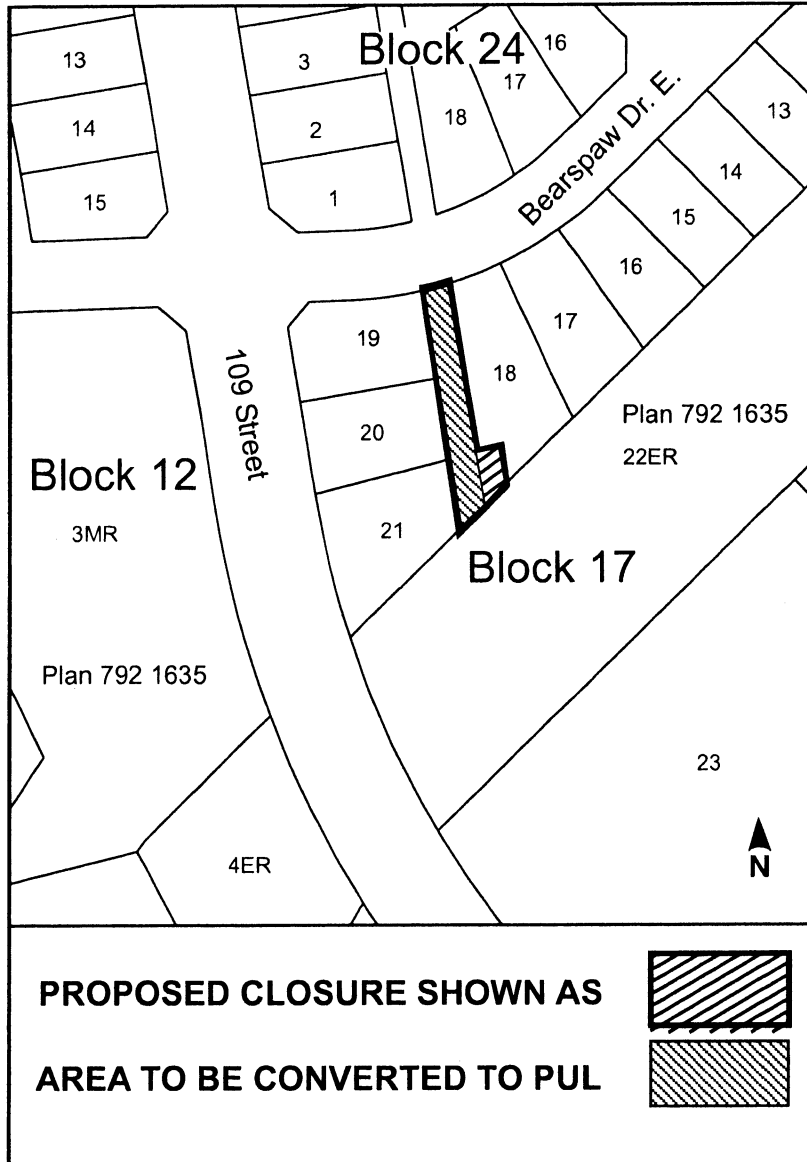
**BYLAW 15247**

**Appendix I**

All that portion of land described as follows:

All that portion of lane in Block 17, Plan 7921635 lying within the limits of Lot 95, Block 17,  
Plan 092\_\_\_\_\_ and

All that portion of lane in Block 17, Plan 7921635 lying within the limits of Lot 96, Block 17,  
Plan 092\_\_\_\_\_

EXCEPTING THEREOUT ALL MINES AND MINERALS.