

CURRENT LEGAL ADDRESS:

LOT 1, BLOCK 59, PLAN 912 3306  
 LAKE DISTRICT (MAYLEWAN) and  
 LOT 2, BLOCK 59, PLAN 912 3306  
 LAKE DISTRICT (MAYLEWAN)

MUNICIPAL ADDRESS: 8140 – 160 AVENUE  
 and 8104 – 160 AVENUE  
 EDMONTON, ALBERTA

TOTAL SITE AREA: 57,127.99 sq. ft. (5,307.19 sq. m.)

EXISTING PARKING: 28 stalls  
 NEW PARKING: 27 stalls  
 TOTAL PARKING: 55 stalls

BLDG. SETBACK REQ.	BLDG. SETBACK PROVIDED
NORTH: 10.0 m (32.81 ft.)	10.07 m (33.04 ft.)
WEST: 6.8 m (22.31 ft.)	8.23 m (27.0 ft.)
EAST: 28.0 m (91.86 ft.)	20.70 m (67.91 ft.)
Pending re-zoning of adjacent property	60.70 m (199.15 ft.)
SOUTH: 24.7 m (81.04 ft.)	24.70 m (81.04 ft.)

LANDSCAPE SETBACK REQ.	LANDSCAPE SETBACK PROVIDED
NORTH: 6.3 m (20.67 ft.)	6.3 m (20.67 ft.)
WEST: 3.5 m (11.48 ft.)	2.43 m (7.97 ft.)
	4.82 m (15.81 ft.)
EAST: 10.7 m (35.15 ft.)	0.83 m (2.72 ft.)
Pending re-zoning of adjacent property	20.22 m (66.34 ft.)
SOUTH: 3.5 m (11.48 ft.)	3.5 m (11.48 ft.)

NEW DEVELOPMENT REQUIREMENTS (EXACT PROVIDED)

ALL REQUIREMENTS ARE BASED ON EDMONTON ZONING BYLAW 12800-SECTION 55.

LANDSCAPE SETBACK (890 SQ. M.)

36 TREES + 60 SHRUBS

LANDSCAPE ISLANDS (75 SQ. M.)

4 TREES + 8 SHRUBS

TOTAL NEW LANDSCAPE (965 SQ. M.)

40 TREES + 68 SHRUBS

20 DECID. = 10-50mm + 10-75mm CALLIPER

20 CONIF. = 15-2.5m + 5-3.5m HEIGHT

34 CONIF. SHRUBS + 34 DECID. SHRUBS

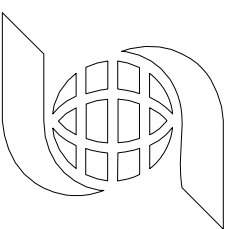

**Scotiabank**  
 THE BANK OF NOVA SCOTIA

REAL ESTATE DEPT.  
 SCOTIA PLAZA  
 44 KING STREET WEST  
 TORONTO, ONTARIO M5H 1H1

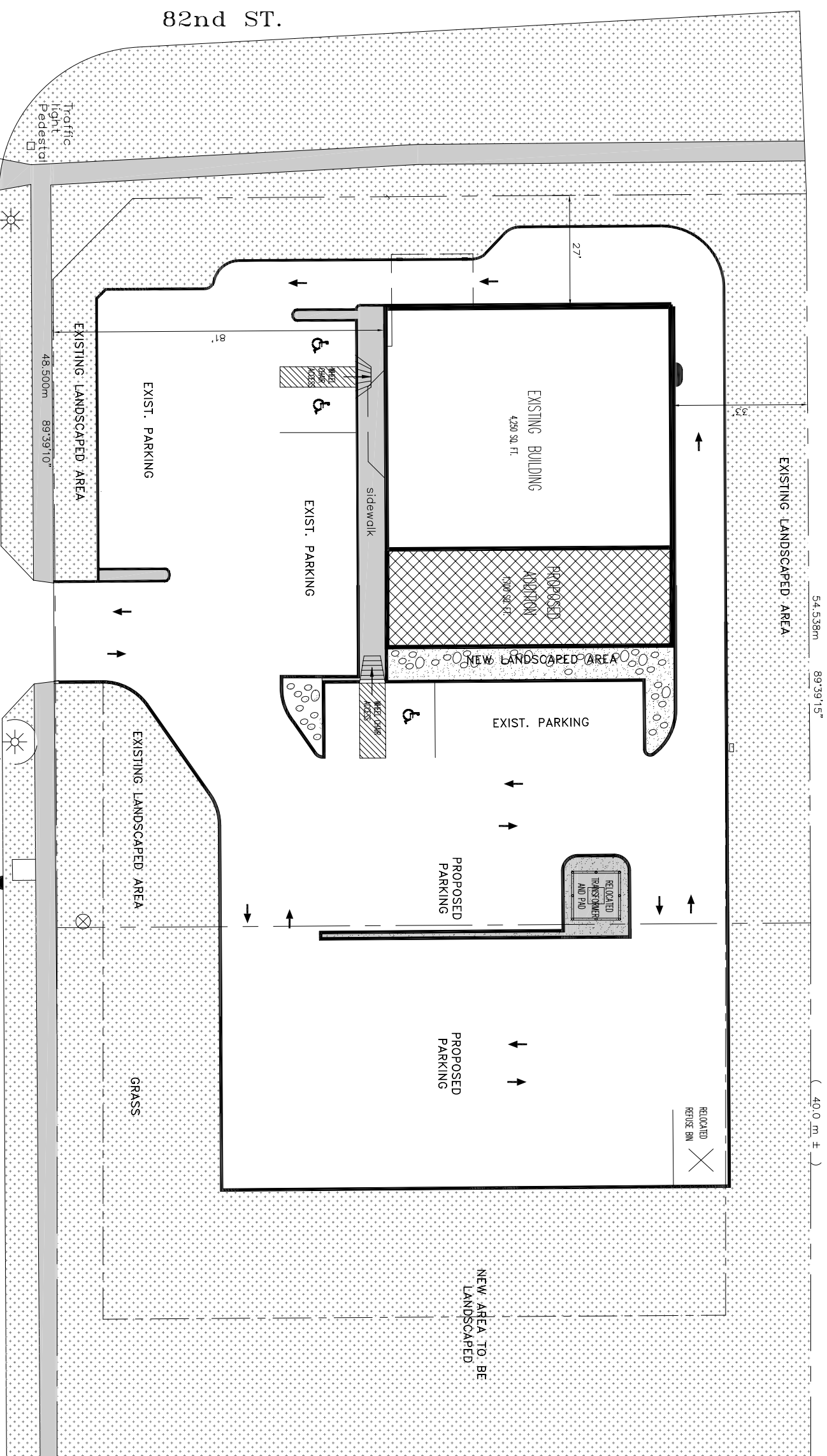

SITE PLAN  
 PROPOSED EXPANSION

SCALE  
 1" = 30'-0"

DATE  
 SEPT. 7, 2007  
 REVISED DATE  
 MAR. 17, 2008

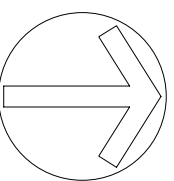

NORTH