

TD NORTHWOOD EDMONTON, AB

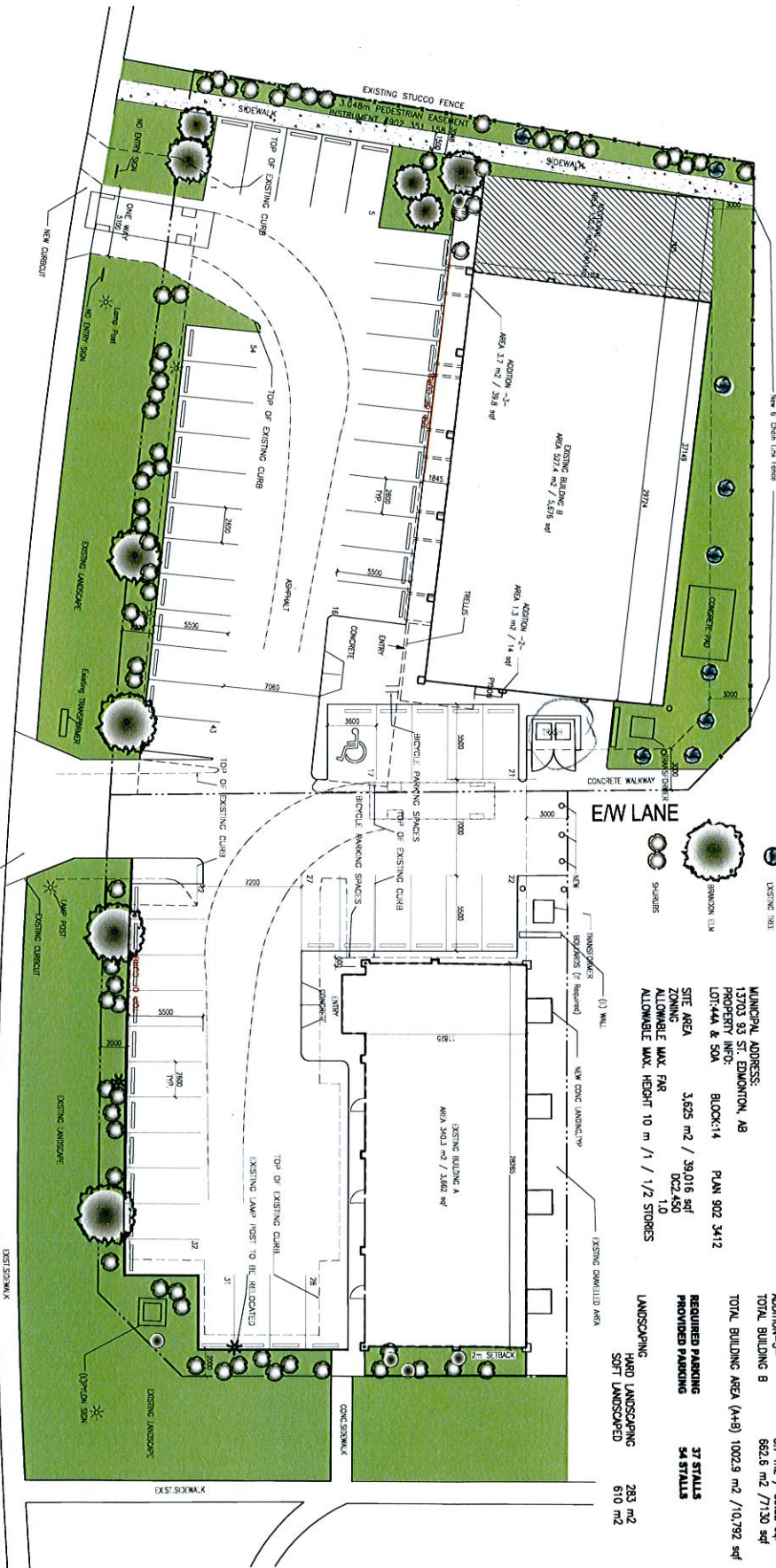

MUNICIPAL ADDRESS: 13703 93 ST. EDMONTON, AB
 BLOCK: 14 PLAN 902 3412
 PROPERTY INFO: LOT: 44A & 50A
 ZONING: DCC2, T10
 SITE AREA: 3,625 m² / 39,016 sqft
 ALLOWABLE MAX. FAR: 0.22, 1.0
 ALLOWABLE MAX. HEIGHT: 10 m / 1 / 1/2 STOREYS

EXISTING BUILDING A	EXISTING BUILDING B	ADDITION-1	ADDITION-2	ADDITION-3	TOTAL BUILDING B	TOTAL BUILDING AREA (A+B)
340.3 m ² / 3,662 sqft	527.4 m ² / 5,676 sqft	1,302.2 m ² / 14,011 sqft	1.3 m ² / 14 sqft	3.7 m ² / 39.82 sqft	662.6 m ² / 7,130 sqft	1,002.9 m ² / 10,792 sqft

REQUIRED PARKING	PROVIDED PARKING	LANDSCAPING
37 STALLS	54 STALLS	HARD LANDSCAPING: 283 m ²
		SOFT LANDSCAPED: 610 m ²

SITE PLAN

SCALE: 1/300

MANU CHUGH ARCHITECT LIMITED

Jan. 09, 2009



137th AVENUE NW