

Charter Bylaw 19816

A Bylaw to amend Bylaw 12800, as amended,
The Edmonton Zoning Bylaw
Amendment No. 3294

WHEREAS lands shown on Schedule “A” and legally described on Schedule “B”; generally located near 105 Avenue NW between 101 Street NW and 115 Street NW, Central McDougall and Queen Mary Park, Edmonton, Alberta, are specified on the Zoning Map as (DC1) Direct Development Control Provision; and

WHEREAS an application was made to rezone the above described property to (DC1) Direct Development Control Provision;

NOW THEREFORE after due compliance with the relevant provisions of the Municipal Government Act RSA 2000, ch. M-26, as amended, the Municipal Council of the City of Edmonton duly assembled enacts as follows:

1. The Zoning Map, being Part III to Bylaw 12800 The Edmonton Zoning Bylaw is hereby amended by rezoning the lands legally described as lands shown on Schedule “A” and legally described on Schedule “B”; generally located near 105 Avenue NW between 101 Street NW and 115 Street NW, Central McDougall and Queen Mary Park, Edmonton, Alberta, which lands are shown on the sketch plan annexed hereto as Schedule “A”, from

(DC1) Direct Development Control Provision to (DC1) Direct Development Control Provision, all as more specifically described on Schedule "B".

READ a first time this	31st day of August	, A. D. 2021;
READ a second time this	31st day of August	, A. D. 2021;
READ a third time this	31st day of August	, A. D. 2021;
SIGNED and PASSED this	31st day of August	, A. D. 2021.

THE CITY OF EDMONTON



MAYOR

A / 

CITY CLERK

CHARTER BYLAW 19816

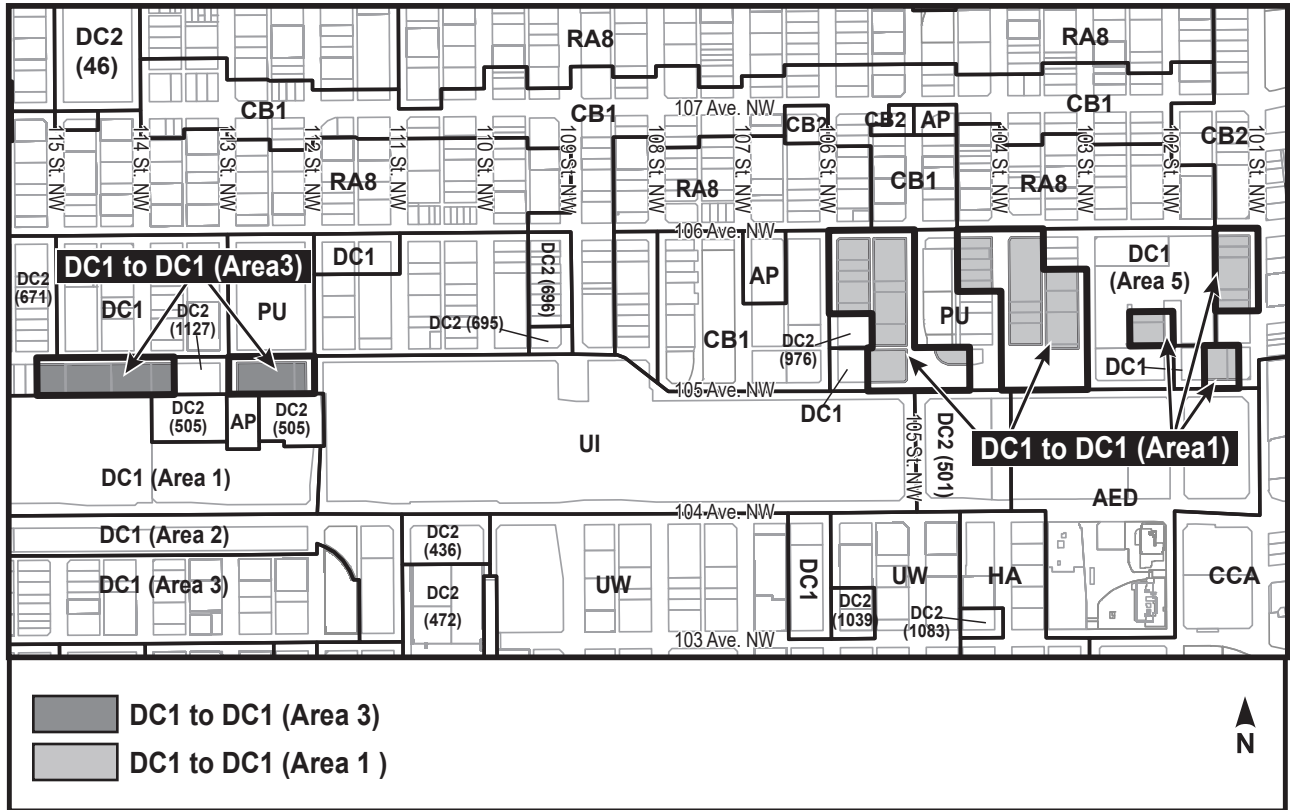

Municipal Address	Legal Address	Zone Change
11403 - 105 AVENUE NW	Plan 9220984 Blk 14 Lot 145A	DC1 to DC1
10502 - 105 AVENUE NW	Plan 9921814 Blk 5 Lot 2	DC1 to DC1
10560 - 105 STREET NW	Plan B3 Blk 5 Lot 233	DC1 to DC1
10567 - 106 STREET NW	Plan B3 Blk 5 Lot 205	DC1 to DC1
10575 - 106 STREET NW	Plan B3 Blk 5 Lot 206	DC1 to DC1
11505 - 105 AVENUE NW	Plan 0020052 Blk 14 Lot 148A	DC1 to DC1
10576 - 101 STREET NW	Plan B3 Blk 1 Lot 263	DC1 to DC1
10576 - 101 STREET NW	Plan B3 Blk 1 Lot 264	DC1 to DC1
11203 - 105 AVENUE NW	Plan 5665CL Blk 12 Lot 167	DC1 to DC1
10112 - 105 AVENUE NW	Plan B3 Blk 1 Lot 228	DC1 to DC1
10550 - 101 STREET NW	Plan B3 Blk 1 Lot 268	DC1 to DC1
10546 - 101 STREET NW	Condominium Plan 9422217, Unit 2	DC1 to DC1
10548 - 101 STREET NW	Condominium Plan 9422217, Unit 1	DC1 to DC1
10530 - 102 STREET NW	Plan B3 Blk 2 Lot 268	DC1 to DC1
10530 - 104 STREET NW	Plan B3 Blk 4 Lot 231	DC1 to DC1
10530 - 104 STREET NW	Plan B3 Blk 4 Lot 232	DC1 to DC1
10530 - 104 STREET NW	Plan B3 Blk 4 Lot 233	DC1 to DC1
10405 - 106 AVENUE NW	Plan B3 Blk 4 Lot 229	DC1 to DC1
10537 - 104 STREET NW	Plan B3 Blk 3 Lot 227	DC1 to DC1
10545 - 104 STREET NW	Plan B3 Blk 3 Lot 228	DC1 to DC1
10560 - 103 STREET NW	Plan 0325618 Blk 3 Lot 259A	DC1 to DC1
10582 - 104 STREET NW	Plan B3 Blk 4 Lot 230	DC1 to DC1
10542 - 105 STREET NW	Plan B3 Blk 5 Lots 234-236	DC1 to DC1

10508 - 105 STREET NW	Plan B3 Blk 5 Lots 236-238	DC1 to DC1
10589 - 106 STREET NW	Plan B3 Blk 5 Lots 207-208	DC1 to DC1
10572 - 101 STREET NW	Plan B3 Blk 1 Lots 265-267	DC1 to DC1
10118 - 105 AVENUE NW	Plan B3 Blk 1 Lots 229-230	DC1 to DC1
10524 - 102 STREET NW	Plan B3 Blk 2 Lots 269-270	DC1 to DC1
10516 - 103 STREET NW	Plan B3 Blk OT	DC1 to DC1
10554 - 103 STREET NW	Plan B3 Blk 3 Lots 260-261	DC1 to DC1
10580 - 104 STREET NW	Plan B3 Blk 4 Lot 230	DC1 to DC1
11355 - 105 AVENUE NW	Plan 5665CL Blk 13 Lots 183-184	DC1 to DC1
10525 - 104 STREET NW	Plan B3 Blk 3 Lots 225-226	DC1 to DC1
10572 - 105 STREET NW	Plan 0521580 Blk 5 Lot 239	DC1 to DC1
10319 - 106 AVENUE NW	Plan 0426394 Blk 3 Lot 265	DC1 to DC1
10546 - 103 STREET NW	Plan B3 Blk 3 Lots 262-264	DC1 to DC1
11425 - 105 AVENUE NW	Condominium Plan 1023143, Units 1 - 182	DC1 to DC1
10404 - 105 AVENUE NW	Plan B3 Blk 4 Lots 193-197	DC1 to DC1
11235 - 105 AVENUE NW	Plan 1820888 Blk 12 Lot 168A	DC1 to DC1
10551 - 106 STREET NW	Plan B3 Blk 5 Lots 203-204	DC1 to DC1
10545 - 106 STREET NW	Plan B3 Blk 5 Lot 202	DC1 to DC1